

DS-1273ZJ-160

Wall Mounting Bracket for Dome Camera

Features:

- Aluminum alloy material with surface spray treatment
- Design with cable entry hole
- Better water proof design
- Convenient installation coordinating with cap

Dimension:

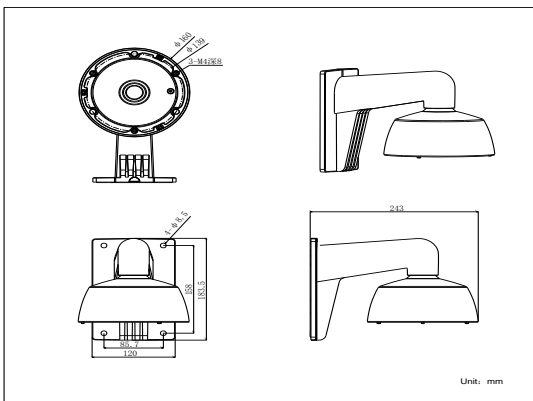

Order Model:

DS-1273ZJ-160



Parameter:

Model	DS-1273ZJ-160
Parameters	Wall Mounting Bracket for Dome Camera
Appearance	Hik White
Range of Application	Suitable for dome camera wall mounting
Material	Aluminum Alloy
Dimension	160×183.5×243mm
Weight	845g

Notice:

- The bracket is for dome camera
- Pay attention to color matching
- The bracket should be installed on flat wall
- The wall must be capable of supporting over 3 times as much as the total weight of the camera and the mount.
- The maximum load capacity of the bracket is 4.5KG

Model Suitable:

DS-2CD72XXF-E(I)Z(H)(S),DS-2CD72X3PF-E(I)Z(H)(S),DS-2CD72X3NF-E(I)Z(H)(S),DS-2CD7293PFWD-E(I)Z(H)(S),DS-2CD7293NFWD-E(I)Z(H)(S),DS-2CD72X4FWD-E(I)Z(H)(S),DS-2CD4312F(WD)-(I)Z(H)(S),DS-2CD4324F-(I)Z(H)(S),DS-2CD4332FWD-(I)Z(H)(S)

Installation Step:

- ① Choose the appropriate wall to install the bracket and wiring

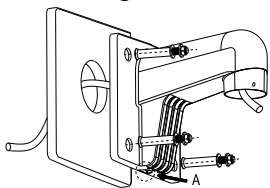

- ② Complete wiring and bracket installation and screw up the cap

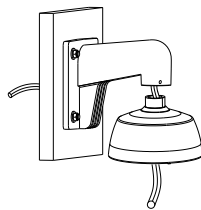

- ③ Fix the connection between bracket and cap with fastening screw

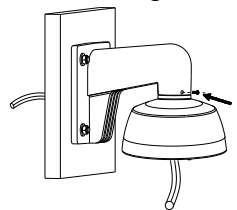

- ④ Take off the lower dome and inner module and base

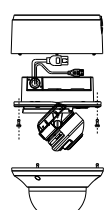

A: Cable entry hole

B: Fastening screw

- ⑤ Complete wiring and fix module to cap

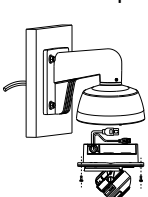

- ⑥ Fix the dome module and adjust the view angle

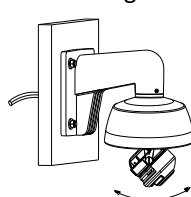

- ⑦ Install lower dome to cap and screw up

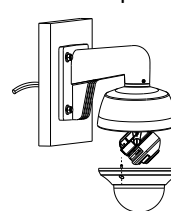

- ⑧ Installation complete

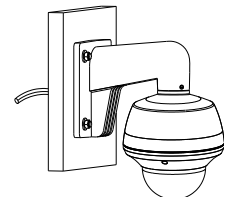

Note: The actual bracket may vary from the picture above.